





## 27, Loxley Close, Macclesfield, Cheshire SK11 8LH

A beautifully presented two double bedroom end-terrace home, ideally situated on a small and charming cul-de-sac just a five-minute walk from the town centre. Offering spacious open-plan living, a modern bathroom, private rear garden, and off-road parking to the front, this property is perfectly located close to the hospital, shops, and restaurants. A warm and welcoming home that would suit individuals, couples, or a small family looking for comfort and convenience.

### Additional Information:

Rent: £1000.00 per calendar month

Deposit: £1,153.00

Holding Deposit: £100.00 - this will be offset against the tenancy deposit once referencing has been passed.

Council Tax Band: C

EPC Rating: C

Available: From 21st August 2026

Maximum number of tenants: 4

Holding Deposit must be paid within 24 hours of an offer being accepted to secure the property.

### Location:

SK11 8LH, Loxley Close.

SK11 8LH, Loxley Close. Located on the left hand side.

**Viewing: By appointment with Holden and Prescott 01625 422244**

**Porch**

3'8" x 2'11"

**Living / Dining Room**

21'4" x 13'6" max

**Kitchen**

8'0" x 6'8"

**Bedroom 1**

11'5" x 10'1"

**Bedroom 2**

9'8" x 7'10"

**Bathroom**

6'4" x 5'4"

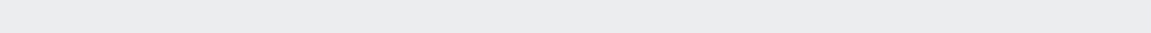

**£1,000 Per Calendar Month**

**HOLDEN & PRESCOTT**

Ground Floor

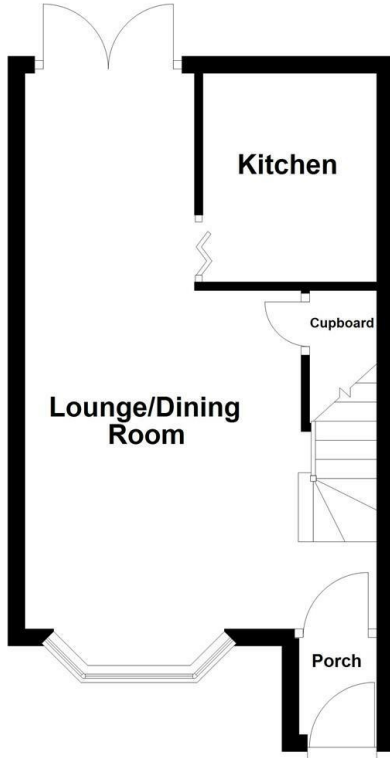

First Floor

